



North Ayrshire Open Art Exhibition 2023 Cover Letter

Contact: Exhibition Co-ordinator

Email: naopenart@gmail.com

Telephone Message service: Harbour Arts Centre, 01294 274049

Website: www.northayrshireopenart.com

Dear Enquirer,

Please find attached information about the North Ayrshire Open Art Exhibition.

PLEASE NOTE THAT WE HAVE NOW DISPENSED WITH ARTWORK LABELS

This Entry Pack includes:

1. AN ENTRY FORM

To be completed and returned by **10th June 2023** to the Exhibition Co-ordinator, c/o Harbour Arts Centre, 114 – 116 Harbour Street, Irvine, KA12 8PZ.

(Do not include the entry fee. This should be paid on the submission day, **Saturday 1st July.**)

****Alternatively, you can apply online by visiting our website at:
www.northayrshireopenart.com****

2. SCULPTURE ENTRY DETAILS & APPLICATION FORM

4. EXHIBITION RULES

Please read over these and retain them for your information.

5. DIAGRAM FOR HANGING FIXTURES

Please make sure that your submissions arrive to us without string and with D-rings attached vertically with rings pointing upwards.

6. KEY DATES OF THE EXHIBITION

Please read these and note that we are unable to arrange alternative submission or collection dates.

7. MAP

For directions to 'The Racquet Hall' at Eglinton Country Park.

Thank you for reading & we look forward to receiving your artwork!



North Ayrshire Open Art Exhibition 2023 Rules

Amateur and professional artists are invited to submit 2 original artworks for selection to the North Ayrshire Open Art Exhibition.

EXHIBITION RULES

- 1 Submitted work in the form of painting, textile, print, drawing, sculptural and 3-dimensional work must be the original work of the exhibitor. The size for individual works is limited to 152cm x 152cm (5ft X 5ft).
- 2 The maximum number of entries per applicant is TWO.
There will be a charge of **£10 for 1 ENTRY, £15 for 2**. Please note that this fee is non-returnable.
- 3 The selection panel's decision is final and there is no guarantee that any individual work will be selected. Criteria for selection of entries will be set as agreed by the selection panel. No feedback on individual works can be given. The selected work will be announced on the exhibition website at: **www.northayrshireopenart.com**
- 4 Pictures must be framed suitably and securely, (**clip frames are not acceptable**). There must be D-rings attached and they must be placed vertically pointing towards the top of the picture. Any cord must be removed. Please see the diagram page attached for instructions. Any work that does not require a frame should still have hanging rings securely attached for exhibition purposes.

This year we have done away with entry labels and instead we will attach a pre-made label to each artwork on submissions day

- 5 Works can be for sale and priced by the exhibitor, **the North Ayrshire Open Art Exhibition Committee charges a commission of 25% on all sales and this should be taken into account when pricing.**
- 6 Exhibitors may submit a typed postcard 10cm x 15cm (6" x 4") with additional information about the artist and work. This information will be held for information purposes only, and destroyed at the conclusion of the exhibition. Please indicate on the entry form if you wish us to give out your email address to visitor enquirers.
- 7 All work should be delivered to the **Racquet Hall on Saturday 1st July between 10.30am and 3pm**. No alternative date or time for delivery can be arranged.

- 8 The selected work will be announced on the exhibition website on **Wednesday 5th July**.

Please visit the site www.northayrshireopenart.com to find out if your work has been successful.

- 9 Unsold and unselected work must be collected from the **Racquet Hall between 12pm and 3pm on Sunday 23rd July**. Failure to collect submissions on this day will result in an additional handling charge of £25 per painting, per day. No alternative date or time can be arranged.

NB. Unselected work will remain in safe storage until collection day. **Unselected work cannot be collected for the duration of the exhibition.**

- 10 **IMPORTANT** – Unfortunately we can't accept responsibility for any loss or damage to the artwork so it's important to arrange your own insurance.

ENTRY FORM

- 11 The entry form must be returned to the exhibition co-ordinator **no later than 10th June 2023**

FAO, Exhibition Co-ordinator, North Ayrshire Open Art Exhibition,
c/o Harbour Arts Centre,
114 – 116 Harbour Street, Irvine, KA12 8PZ

Or apply online at: www.northayrshireopenart.com

- 12 Please ensure that the details on the label are correct and legible, no late alterations to labels can be accepted.

PAYMENTS

- 13 The entry fees are **£10 for 1 ENTRY & £15 for 2 ENTRIES**.
- 14 If you are submitting sculpture, please read the separate information sheet and follow the instructions for paying fees.
- 15 All other entry fees should be paid on Submission Day (**Saturday 1st July 2023**) Payment should be cash or cheque, which should be made payable to NORTH AYRSHIRE OPEN ART EXHIBITION.



North Ayrshire Open Art Exhibition 2023 Entry Form

Return to
Email address
Address

Exhibition Co-ordinator
naopenart@gmail.com
c/o Harbour Arts Centre, 114-116 Harbour Street, Irvine, KA12 8PZ

Artist's Name	
Address	
Post Code	
Email	
Mobile Phone No.	
Total number of works Submitted (max 2)	
Artist's Signature	
Do you give permission for your email address to be given to enquirers?	YES/NO

ENTRY 1	
TITLE	
MEDIUM	
SUBJECT MATTER	
GROSS PRICE	

ENTRY 2	
TITLE	
MEDIUM	
SUBJECT MATTER	
GROSS PRICE	

FOR OFFICIAL USE ONLY

Date received		Entry Fee received	
Receiving Number			
Catalogue Number			



North Ayrshire Open Art Exhibition 2023 Hanging Fixings Instructions

Please refer to these instructions when preparing your artwork for submission.

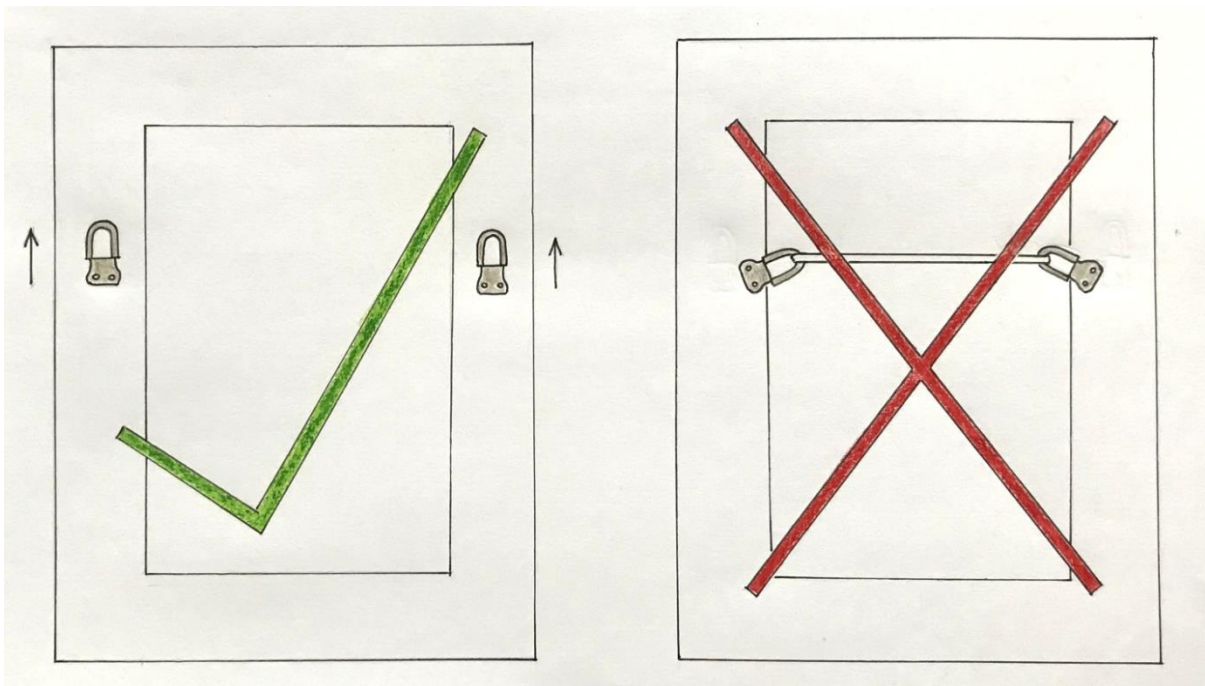

D-Rings should be attached vertically as shown above.
Cord should be removed.

Please make sure that your framed artwork conforms to this example to allow us to hang it properly.

Thank you.



North Ayrshire Open Art Exhibition 2023 Sculpture Information

**FOR SCULPTURE SUBMISSIONS ONLY - INFORMATION FOR EMAIL
SUBMISSION AND SELECTION OF SCULPTURE ENTRIES**
(Please also read the full exhibition rules)

Artists can submit sculpture for selection from photographs prior to the main submission date. Artists can submit via email to: naopenart@gmail.com

The entry must include a completed application form & one image of each sculpture. The images must have a title & be in JPG format.

There will be a charge of **£10 FOR 1 ENTRY, £15 FOR 2 ENTRIES** and this should be paid direct to North Ayrshire Open Art Exhibition by electronic bank transfer to Bank of Scotland:

Account name: North Ayrshire Open Art Exhibition

Sort Code: 80 08 42

Account No: 00761176

Reference: Please state your name on the payment.

The closing date for electronic submissions is earlier than the general submission date. **Closing date for submission by email is Friday 23rd June. Payment should be made before this date.**

You will receive notification of selection by email by Monday 26th June.

If successful, your sculpture should be delivered to the Racquet Hall on **Saturday 1st July between the hours of 10.30am & 3pm.**

The artist is responsible for supplying any display plinth required for the work. Wall mounted work should be prepared with hanging rings positioned vertically and without cord



North Ayrshire Open Art Exhibition 2023 Sculpture Entry Form

Return to
Email address

Exhibition Co-ordinator
naopenart@gmail.com

Artist's Name		
Address		
Post Code		
Email		
Mobile Phone No.		
Total number of works Submitted (max 2)		
Artist's Signature		
Do you give permission for your email address to be given to enquirers?	YES/NO	

ENTRY 1	
TITLE	
MEDIUM	
DIMENSIONS	
WEIGHT	
GROSS PRICE	

ENTRY 2	
TITLE	
MEDIUM	
DIMENSIONS	
WEIGHT	
GROSS PRICE	

Please email a jpeg image of each sculpture to naopenart@gmail.com

FOR OFFICIAL USE ONLY

Date received		Entry Fee received	
Receiving Number			
Catalogue Number			



North Ayrshire Open Art Exhibition 2023

Key Dates

Please read this and retain for your information

Saturday 10th June: Application Deadline

All application forms should be delivered to the Harbour Arts Centre.

[You can also apply online via: www.northayrshireopenart.com](http://www.northayrshireopenart.com)

Saturday 1st July: Submissions Day

All artwork should be delivered to 'The Racquet Hall' at Eglinton Country Park between the hours of 10.30am & 3pm. (We are unable to arrange an alternative submission date or time.) Payment should be made on this day only.

Sunday 2nd July: Selection Day

Three independent art professionals will select from the submissions.

Please note that rejection of a submission bears no reflection on artistic talent. We have many artworks being submitted that inevitably many quality works will be omitted due to a lack of space

Wednesday 5th July: Artist List Posted Online

A list of successful submissions will be posted on our website at:

<https://www.northayrshireopenart.com>

Thursday 6th July: Prizes Allocated

Our Sponsors will attend the 'Racquet Hall' and pick their prize winners. All prize winners will then be contacted by phone or email.

Saturday 8th July to Saturday 22nd July: The exhibition will be open to the public everyday between the hours of 10am & 4pm.

Sunday 23rd July: All un-exhibited & un-sold works must be collected from 'The Racquet Hall' between the hours of 12 noon & 3pm.

EGLINTON

COUNTRY PARK

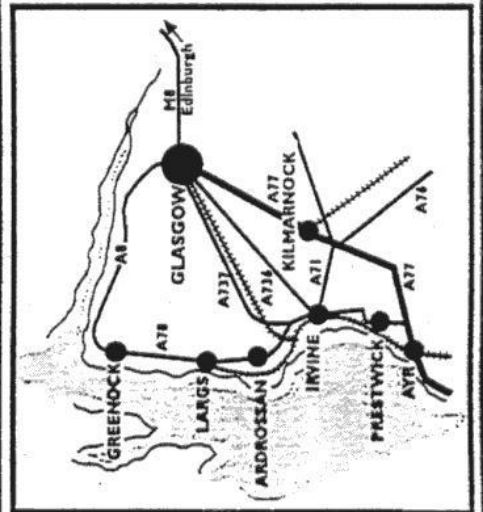
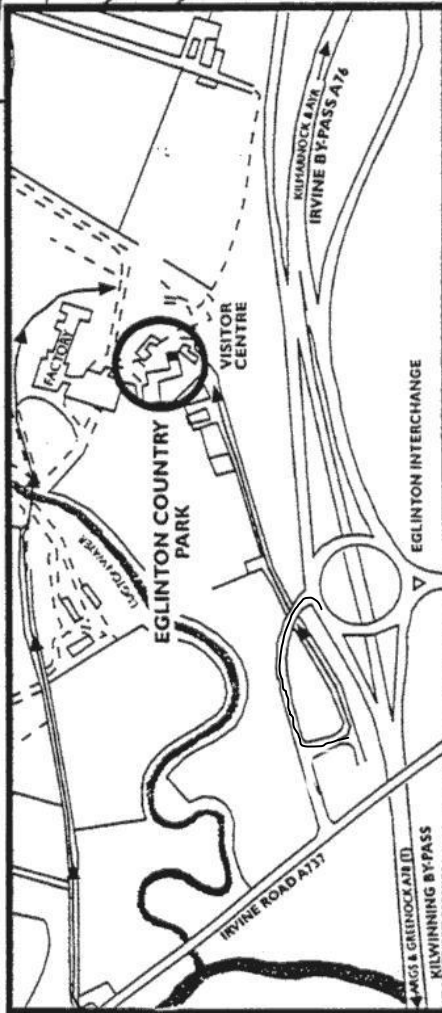

FACTORY

RACQUET HALL

COURTYARD

CAFE

VISITOR CENTRE

APPROACH ROAD

Please use Car Park **B**

CAR PARK B

CAR ACCESS TO RACQUET HALL