



# North Ayrshire Open Art Exhibition 2022

## Cover Letter

**Contact:** Exhibition Co-ordinator

**Email:** [naopenart@gmail.com](mailto:naopenart@gmail.com)

**Telephone Message service:** Harbour Arts Centre, 01294 274049

**Website:** [www.northayrshireopenart.com](http://www.northayrshireopenart.com)

Dear Enquirer,

Please find attached information about the North Ayrshire Open Art Exhibition.

This Entry Pack includes:

### **1. AN ENTRY FORM**

To be completed and returned by **13<sup>th</sup> June 2022** to the Exhibition Co-ordinator, c/o Harbour Arts Centre, 114 – 116 Harbour Street, Irvine, KA12 8PZ.

(Do not include the entry fee. This should be paid on the submission day, **Saturday 2<sup>nd</sup> July.**)

Alternatively you can email the entry form to [naopenart@gmail.com](mailto:naopenart@gmail.com)

### **2. TWO ENTRY LABELS** – one for each entry

Each label has three sections - please complete all the sections and attach a label to the back of each artwork.

### **3. SCULPTURE ENTRY DETAILS & APPLICATION FORM**

### **4. EXHIBITION RULES**

Please read over these and retain them for your information.

### **5. DIAGRAM FOR HANGING FIXTURES**

Please make sure that your submissions arrive to us without string and with D-rings attached vertically with rings pointing upwards.

### **6. KEY DATES OF THE EXHIBITION**

Please read these and note that we are unable to arrange alternative submission or collection dates.

### **7. MAP**

For directions to 'The Racquet Hall' at Eglinton Country Park.

**Thank you for reading & we look forward to receiving your artwork!**



# North Ayrshire Open Art Exhibition 2022

## Rules

Amateur and professional artists are invited to submit 2 original artworks for selection to the North Ayrshire Open Art Exhibition.

## EXHIBITION RULES

- 1 Submitted work in the form of painting, textile, print, drawing, sculptural and 3-dimensional work must be the original work of the exhibitor. The size for individual works is limited to 152cm x 152cm (5ft X 5ft).
- 2 The maximum number of entries per applicant is TWO.  
There will be a charge of **£10 for 1 ENTRY, £15 for 2**. Please note that this fee is non-returnable.
- 3 The selection panel's decision is final and there is no guarantee that any individual work will be selected. Criteria for selection of entries will be set as agreed by the selection panel. No feedback on individual works can be given. The selected work will be announced on the exhibition website at: [www.northayrshireopenart.com](http://www.northayrshireopenart.com)
- 4 Pictures must be framed suitably and securely, (**clip frames are not acceptable**). There must be D-rings attached and they must be placed vertically pointing towards the top of the picture. Any cord must be removed. Please see the diagram page attached for instructions. A **completed entry label** should be secured to the back of each work. Any work that does not require a frame should still have hanging rings securely attached for exhibition purposes.
- 5 Works can be for sale and priced by the exhibitor, **the North Ayrshire Open Art Exhibition Committee charges a commission of 25% on all sales and this should be taken into account when pricing.**
- 6 Exhibitors may submit a typed postcard 10cm x 15cm (6" x 4") with additional information about the artist and work. This information will be held for information purposes only, and destroyed at the conclusion of the exhibition. Please indicate on the entry form if you wish us to give out your email address to visitor enquirers.
- 7 All work should be delivered to the **Racquet Hall on Saturday 2<sup>nd</sup> July 2022 between 10.30am and 4pm**. No alternative date or time for delivery can be arranged.
- 8 The selected work will be announced on the exhibition website on **Wednesday 6<sup>th</sup> July**.

Please visit the site **[www.northayrshireopenart.com](http://www.northayrshireopenart.com)** to find out if your work has been successful.

- 9 Unsold and unselected work must be collected from the **Racquet Hall between 12pm and 4pm on Sunday 24<sup>th</sup> July**. Failure to collect submissions on this day will result in an additional handling charge of £25 per painting, per day. No alternative date or time can be arranged.

NB. Unselected work will remain in safe storage until collection day. **Unselected work cannot be collected for the duration of the exhibition.**

- 10 **IMPORTANT** – Unfortunately we can't accept responsibility for any loss or damage to the artwork so it's important to arrange your own insurance.

## ENTRY FORMS AND LABELS

**PLEASE COMPLETE AN ENTRY FORM (1 ONLY) AND A LABEL FOR EACH WORK SUBMITTED.**

- 11 The entry form must be returned to the exhibition co-ordinator **no later than 13th June 2022** and the labels retain by the artist & attached securely to each entry.

For the attention of  
Exhibition Co-ordinator, North Ayrshire Open Art Exhibition,  
c/o Harbour Arts Centre,  
114 – 116 Harbour Street, Irvine, KA12 8PZ

**OR attach the forms to an email:**

**Contact:** Exhibition Co-ordinator  
**Email:** [naopenart@gmail.com](mailto:naopenart@gmail.com)  
**Website:** [northayrshireopenart.com](http://northayrshireopenart.com)

- 12 **Please ensure that the details on the label are correct and legible, no late alterations to labels can be accepted.**

## PAYMENTS

- 13 The entry fees are **£10 for 1 ENTRY & £15 for 2 ENTRIES.**
- 14 If you are submitting sculpture for early selection please read the separate information sheet and follow the instructions for paying fees.
- 15 All other entry fees should be paid on Submission Day (Saturday 2<sup>nd</sup> July 2022)  
Payment should be cash or cheque, which should be made payable to NORTH AYRSHIRE OPEN ART EXHIBITION. **Please note that if there is internet connection available we may be able to accept debit or credit cards, however, cash or cheque should be brought in case of a connection failure.**



# North Ayrshire Open Art Exhibition 2022 Entry Form

Return to  
Email address  
Address

Exhibition Co-ordinator  
naopenart@gmail.com  
c/o Harbour Arts Centre, 114-116 Harbour Street, Irvine, KA12 8PZ

Artist's Name		
Address		
Post Code		
Email		
Telephone		
Total number of works Submitted (max 2)		
Artist's Signature		
Do you give permission for your email address to be given to enquirers?		YES/NO
For future submissions would you prefer an online application process?		YES/NO

<b>ENTRY 1</b>	
TITLE	
MEDIUM	
DIMENSIONS	
GROSS PRICE	

<b>ENTRY 2</b>	
TITLE	
MEDIUM	
DIMENSIONS	
GROSS PRICE	

## FOR OFFICIAL USE ONLY

Date received		Entry Fee received	
Receiving Number			
Catalogue Number			

THIS IS YOUR ENTRY LABEL. Please retain as directed

OPEN ART EXHIBITION

Part A to be attached securely to the art work on submission

Artist's name in BLOCK LETTERS

Title

A	Gross Price		Official Use Receiving Number							
	£									
	CUT HERE									
	<div><div>The North Ayrshire Open Art Exhibition</div><div>Submit parts B and C to the Receiving officer</div></div> <div>Artist's name in BLOCK CAPITALS</div> <div>Address</div> <div>Telephone no.</div> <div>Email</div> <div>Title</div> <div>Gross price (if not for sale enter XX) £</div> <div>Official use</div> <div>£</div> <div>Entry fee</div> <div>Receiving Number</div> <div>Catalogue Number</div> <div>Total number of works submitted by the Artist</div> <div>Artist's signature</div>									
	CUT HERE									
	<div><div>OPEN ART EXHIBITION</div><div>Part C to be retained by the Artist</div></div> <div>Artist's name in BLOCK LETTERS</div> <div>Title</div> <div>Official use</div> <table><tr><td>C</td><td>Gross Price</td><td>Official Use Receiving Number</td></tr><tr><td></td><td>£</td><td></td></tr></table>					C	Gross Price	Official Use Receiving Number		£
C	Gross Price	Official Use Receiving Number								
	£									

THIS IS YOUR ENTRY LABEL. Please retain as directed

OPEN ART EXHIBITION

Part A to be attached securely to the art work on submission

Artist's name in BLOCK LETTERS

Title

A	Gross Price		Official Use Receiving Number							
	£									
	CUT HERE									
	<div><div>The North Ayrshire Open Art Exhibition</div><div>Submit parts B and C to the Receiving officer</div></div> <div>Artist's name in BLOCK CAPITALS</div> <div>Address</div> <div>Telephone no.</div> <div>Email</div> <div>Title</div> <div>Gross price (if not for sale enter XX) £</div> <div>Official use</div> <div>£</div> <div>Entry fee</div> <div>Receiving Number</div> <div>Catalogue Number</div> <div>Total number of works submitted by the Artist</div> <div>Artist's signature</div>									
	CUT HERE									
	<div><div>OPEN ART EXHIBITION</div><div>Part C to be retained by the Artist</div></div> <div>Artist's name in BLOCK LETTERS</div> <div>Title</div> <div>Official use</div> <table><tr><td>C</td><td>Gross Price</td><td>Official Use Receiving Number</td></tr><tr><td></td><td>£</td><td></td></tr></table>					C	Gross Price	Official Use Receiving Number		£
C	Gross Price	Official Use Receiving Number								
	£									



## North Ayrshire Open Art Exhibition 2022 Hanging Fixings Instructions

Please refer to these instructions when preparing your artwork for submission.

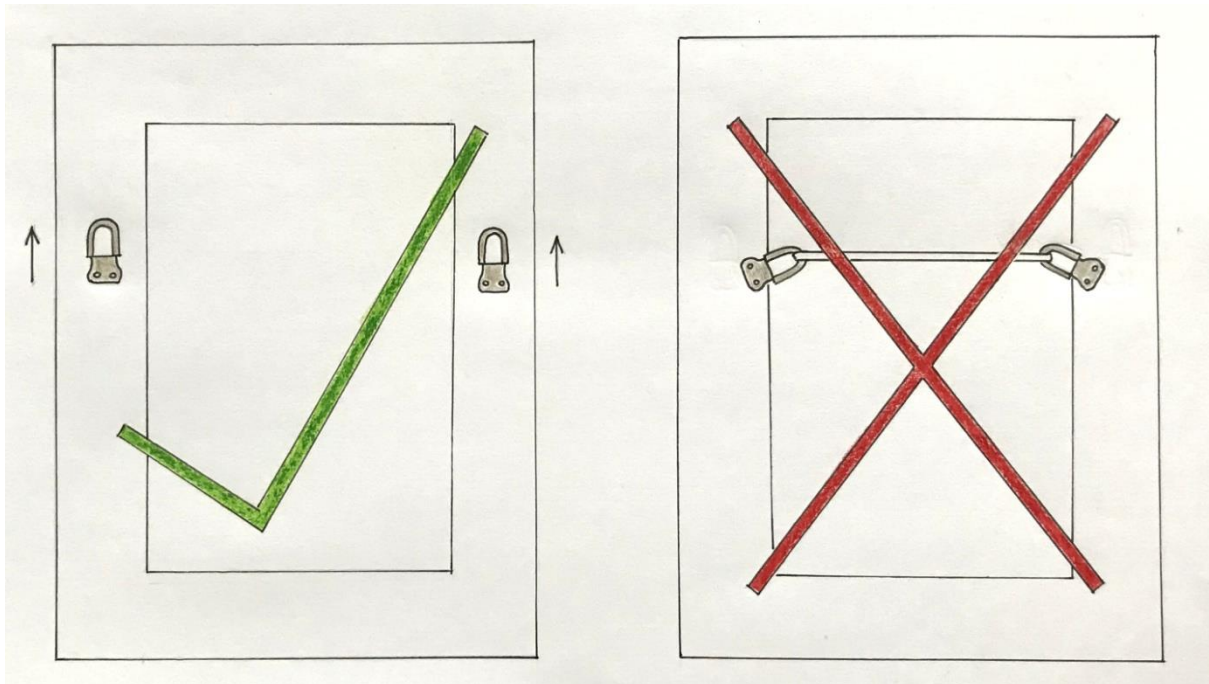

D-Rings should be attached vertically as shown above.

Cord should be removed.

Please make sure that your framed artwork conforms to this example to allow us to hang it properly.

Thank you.



# North Ayrshire Open Art Exhibition 2022

## Sculpture Information

### **FOR SCULPTURE SUBMISSIONS ONLY - INFORMATION FOR ELECTRONIC SUBMISSION AND SELECTION OF SCULPTURE ENTRIES**

(Please also read the full exhibition rules)

Artists can submit sculpture for selection from photographs prior to the main submission date. Artists can submit via email to: [naopenart@gmail.com](mailto:naopenart@gmail.com)

The entry must include a completed application form & up to 3 images of each sculpture. The images must be numbered, have a title & be in JPG format.

There will be a charge of **£10 FOR 1 ENTRY, £15 FOR 2 ENTRIES** and this should be paid direct to North Ayrshire Open Art Exhibition by electronic bank transfer to Bank of Scotland:

**Account name: North Ayrshire Open Art Exhibition**

**Sort Code: 80 08 42**

**Account No: 00761176**

**Reference: Please state your name on the payment.**

The closing date for electronic submissions is earlier than the general submission date.

**Closing date for submission by email is Friday 24th June.**

You will receive notification of selection by email on **Thursday 30<sup>th</sup> June.**

If successful, your sculpture should be delivered to the Racquet Hall on **Saturday 2<sup>nd</sup> July between the hours of 10.30am & 4pm.**

On delivery of selected sculpture a completed entry label should be attached securely to each work. **The artist is responsible for supplying any display plinth required for the work.** Wall mounted work should be prepared with hanging rings positioned vertically and without cord.



# North Ayrshire Open Art Exhibition 2022

## Sculpture Entry Form

Return to  
Email address

Exhibition Co-ordinator  
naopenart@gmail.com

Artist's Name		
Address		
Post Code		
Email		
Mobile Phone No.		
Total number of works Submitted (max 2)		
Artist's Signature		
Do you give permission for your email address to be given to enquirers?	YES/NO	
For future submissions would you prefer an online application process?	YES/NO	

<b>ENTRY 1</b>	
TITLE	
MEDIUM	
DIMENSIONS	
WEIGHT	
GROSS PRICE	

<b>ENTRY 2</b>	
TITLE	
MEDIUM	
DIMENSIONS	
WEIGHT	
GROSS PRICE	

**Remember to include up to 3 images of each artwork**

### FOR OFFICIAL USE ONLY

Date received		Entry Fee received	
Receiving Number			
Catalogue Number			





# North Ayrshire Open Art Exhibition 2022

## Key Dates

Please read this and retain for your information

### **Monday 13<sup>th</sup> June: Application Deadline**

All application forms should be delivered to the Harbour Arts Centre or emailed to:  
[naopenart@gmail.com](mailto:naopenart@gmail.com)

### **Saturday 2<sup>nd</sup> July: Submissions Day**

All artwork should be delivered to 'The Racquet Hall' at Eglinton Country Park between the hours of 10.30am & 4pm. (We are unable to arrange an alternative submission date or time.) Payment should be made on this day only.

### **Sunday 3<sup>rd</sup> July: Selection Day**

Three independent art professionals will select from the submissions.

\*Please note that rejection of a submission bears no reflection on artistic talent. We have so many artworks being submitted that inevitably many quality works will be omitted due to a lack of space.\*

### **Wednesday 6<sup>th</sup> July: Artist List Posted Online**

A list of successful submissions will be posted on our website at:

<https://www.northayrshireopenart.com>

### **Thursday 7<sup>th</sup> July: Prizes Allocated**

Our Sponsors will attend the 'Racquet Hall' and pick their prize winners. All prize winners will then be contacted by phone or email.

**Saturday 9<sup>th</sup> July to Saturday 23<sup>rd</sup> July:** The exhibition will be open to the public everyday between the hours of 10am & 4pm.

**Sunday 24<sup>th</sup> July:** All un-exhibited & un-sold works must be collected from 'The Racquet Hall' between the hours of 12 & 4pm.

# EGLINTON

COUNTRY PARK



FACTORY

RACQUET HALL

COURTYARD

CAFE

VISITOR CENTRE

FOOTPATH

FOOTPATH

FOOTPATH

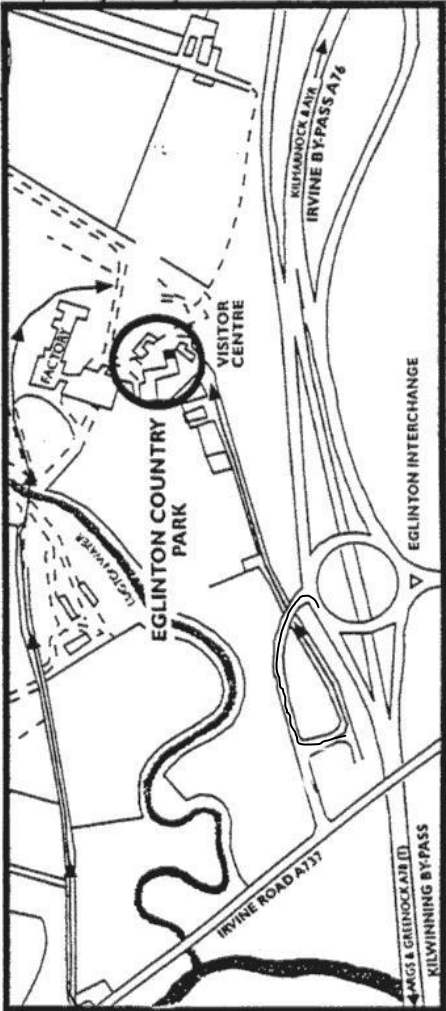

APPROACH ROAD

Please use Car Park **B**

CAR PARK **B**

CAR ACCESS TO RACQUET HALL

